

Closed type milk cooling tanks

Keep your milk safe

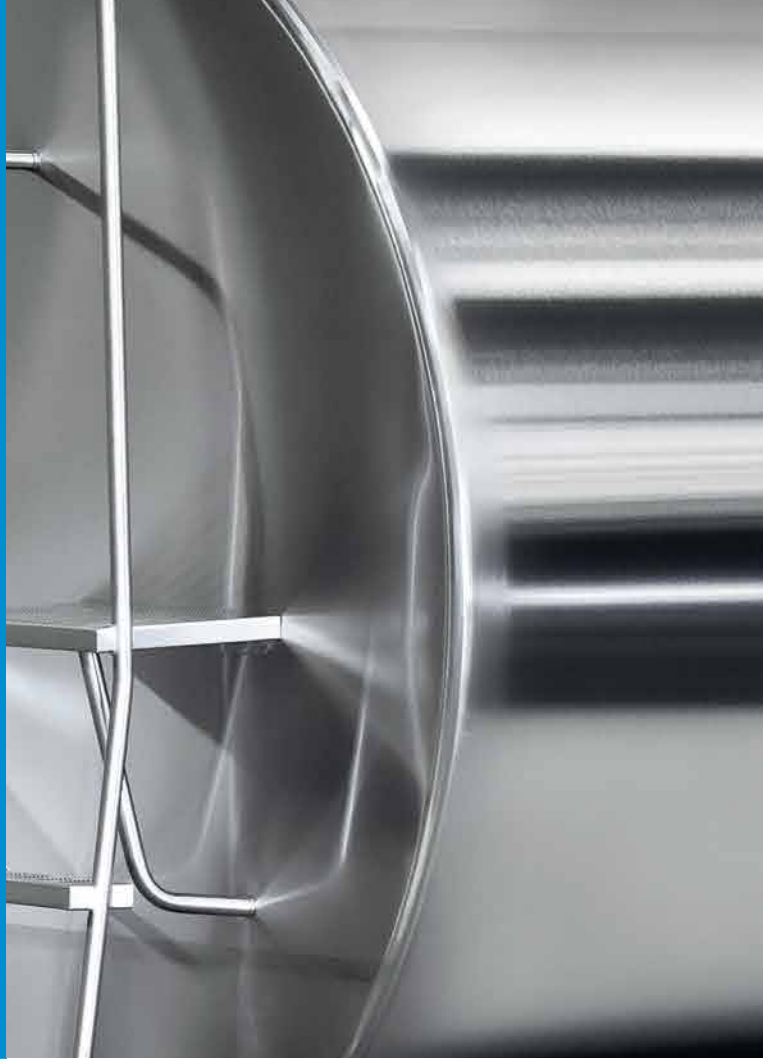

MILK COOLING

Milkplan[®]
FARMING TECHNOLOGIES

MP Powertank

The stainless steel milk cooling tanks MP Powertank are horizontal tanks in two types (round and elliptical) with access manholes and two options for automatic cooling and washing control systems. They are manufactured according to the highest European and American quality standards.



Technical specifications

- Agitation motor by the French company Sirem, 21-25 rpm.
- Cooling units with Tecumseh, Maneurop and Copeland compressors.
- Special thermal insulation with ecological and high-density, environmentally-friendly two-component polyurethane foam.
- Made entirely of anti-magnetic stainless steel 18/10, DIN 1.4301 (AISI 304) with special finish processing.
- Specially-designed laser-welded evaporator for more efficient milk cooling. The evaporator's design prevents freezing of even small amounts of milk.
- With an integrated automatic washing control system, two options (MPP Standard or MPP Control).
- Stainless steel external pressure equalizer.
- Stainless steel adjustable feet.



Operating characteristics

- For 2, 4 and 6 milkings.
- Temperature sensor, easily accessible for replacement.
- Manhole that seals without plastic flange use.
- Rotating spraydish for washing the interior of the cooling tank.

Plus

Optional equipment:

- Electronic measuring system with a stainless steel, high-precision meter of +/-0,5%.
- Automatic weighing system installed on the cooling tank feet (high-precision weighing system ($\pm 0,1\%$) with an independent LCD display with 4, 6, 8 load cells).
- Self-cleaning valve.
- Disinfection cycle.
- Connection to a data recorder.
- Pre-installation of evaporators for future conversion of the cooling tank from 4 to 2 milkings.
- Cooling units for particularly warm climates (Tropical +43°C).
- Various options of stainless steel valve threads DN, SMS, IDF, TRICLAMP.



Cooling and washing systems

STANDARD

Standard version of automatic washing system (PLC)

The system controls the cooling and agitation functions as well as the full washing in five cycles; cold pre-wash, hot pre-wash, main hot wash, hot rinse, cold rinse with manual cooling/washing option easy-to-use in operation.

It includes:

- Independent peristaltic pumps for detergent and acid.
- Drain valve of Ø50mm.
- Electronic thermometer - thermostat with an integrated Dixell agitation program.
- Independent solenoid valves (¾") for hot and cold water supply.
- Automatic operation with the Schneider electronic controller (PLC) with fully adjustable parameters and an option for software update.
- Sirem's powerful washing pump for constant flow and proper spray pressure.
- Special rotating blades for water spraying during washing.

CONTROL

Full version of the automatic washing system (PLC)

All parameters for the proper cooling, agitation and washing, as well as all necessary information for the operation of the cooling tank are configured through a programmable logic controller (PLC). The easy-to-use control panel is installed in the front part of each cooling tank within a stainless steel (AISI 304) construction.

In addition, the system provides:

- A full system of 14 alarms.
- An electronic thermometer (backup controller) and a cooling and agitation thermostat by Dixell of an IP 65 sealing rating.
- A backlit and waterproof (IP65) digital LCD display.
- An audible alarm in case of a problem.
- Optional addition of a stainless steel, three-phase electric resistance heater.



MPP Round

Capacities from 1,000lt - 14,000lt. For 2, 4 and 6 milkings.

| Tank Type | W / H1 | W1 | H2 | H3 | Hm | H | L | L1 | A | Legs | Agitators |
|-----------|--------|------|------|------|-----|------|------|------|-----|------|-----------|
| MPP 1500 | 1350 | 800 | 1590 | 1830 | 620 | 2290 | 1550 | 950 | 300 | 4 | 1 |
| MPP 2000 | 1350 | 800 | 1590 | 1830 | 620 | 2290 | 2020 | 1010 | 505 | 4 | 1 |
| MPP 2500 | 1350 | 800 | 1590 | 1780 | 620 | 2290 | 2350 | 1450 | 450 | 4 | 1 |
| MPP 3000 | 1350 | 800 | 1590 | 1780 | 620 | 2290 | 2900 | 1400 | 750 | 4 | 1 |
| MPP 3500 | 1350 | 800 | 1590 | 1780 | 620 | 2290 | 3400 | 975 | 725 | 6 | 1 |
| MPP 4000 | 1680 | 990 | 1870 | 2055 | 720 | 2520 | 2370 | 1400 | 485 | 4 | 1 |
| MPP 5000 | 1680 | 990 | 1870 | 2055 | 720 | 2520 | 2900 | 1400 | 750 | 4 | 1 |
| MPP 6000 | 1680 | 990 | 1870 | 2055 | 720 | 2520 | 3500 | 1400 | 350 | 6 | 1 |
| MPP 8000 | 1990 | 1090 | 2130 | 2315 | 720 | 2990 | 3341 | 1200 | 470 | 6 | 2 |
| MPP 10000 | 1990 | 1090 | 2130 | 2315 | 720 | 2990 | 4160 | 1600 | 480 | 6 | 2 |
| MPP 12000 | 2230 | 1450 | 2410 | 2595 | 720 | 3200 | 3830 | 1340 | 575 | 6 | 2 |
| MPP 14000 | 2230 | 1450 | 2410 | 2595 | 720 | 3200 | 4500 | 1650 | 600 | 6 | 2 |

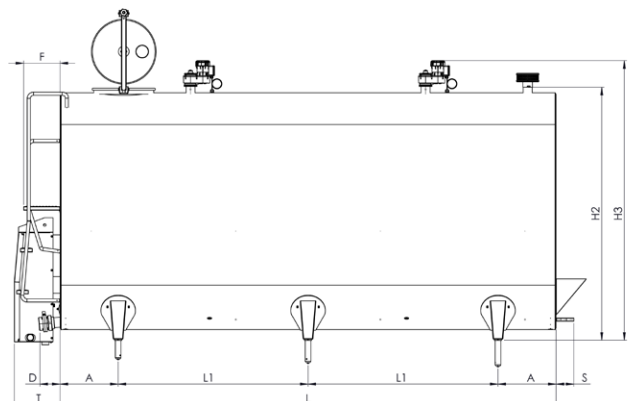
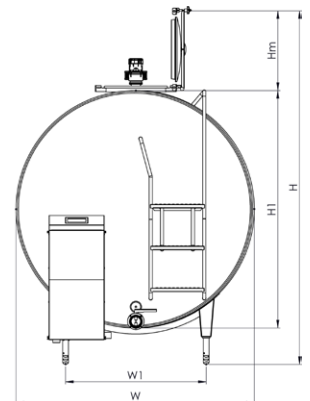

MPP Oval (Elliptical)

Capacities from 10,000lt - 20,000lt. For 2, 4 and 6 milkings.
 For faster cooling of larger amounts of milk.
 An ideal solution for places where there is a height limitation.

| Tank Type | W | W1 | H1 | H2 | H3 | Hm | H | L | L1 | A | Legs | Agitators |
|------------|------|------|------|------|------|-----|------|------|------|-----|------|-----------|
| MPPO 10000 | 2300 | 1440 | 1900 | 2040 | 2290 | 720 | 2965 | 3600 | 1400 | 400 | 6 | 2 |
| MPPO 12000 | 2300 | 1440 | 1900 | 2040 | 2290 | 720 | 2965 | 4430 | 1550 | 665 | 6 | 2 |
| MPPO 14000 | 2300 | 1440 | 1900 | 2040 | 2290 | 720 | 2965 | 4980 | 1550 | 980 | 6 | 2 |
| MPPO 16000 | 2300 | 1440 | 1900 | 2040 | 2290 | 720 | 2965 | 5790 | 1550 | 700 | 8 | 2 |
| MPPO 18000 | 2300 | 1440 | 1900 | 2040 | 2290 | 720 | 2965 | 6425 | 1550 | 960 | 8 | 3 |
| MPPO 20000 | 2300 | 1440 | 1900 | 2040 | 2290 | 720 | 2965 | 7200 | 1550 | 500 | 10 | 3 |

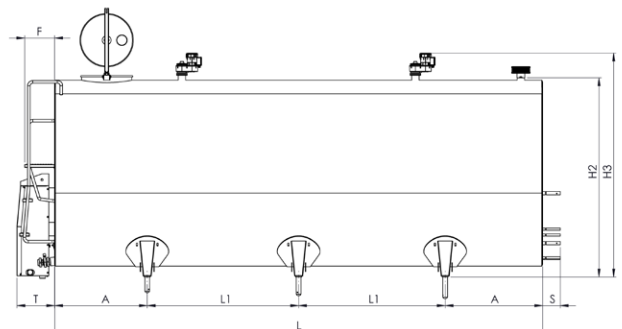
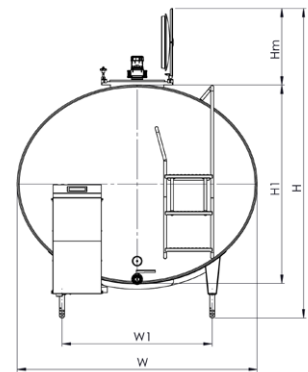



09109102402
09109102402



3rd km. Provincial road Lagada - Kolchiko
572 00 Lagadas, Thessaloniki Greece

T/F +30 23940 20400
E sales@milkipan.com

www.milkipan.com